



**KitLock**   
by CodeLocks

smarter access for **everyone**



## CONTROL + CONVENIENCE

Codelocks is an innovative designer and distributor of locks, from robust and stylish mechanical locks to cutting-edge electronic and smart locks that use the latest technologies.

The locks can be used for a variety of applications, including doors, cabinets, lockers and enclosures. Access control is made easy, whether the application involves limiting building and room access or safeguarding confidential or hazardous materials.

Convenience is at the heart of Codelocks products, which are designed to be user-friendly and give you complete control over who has access. The locks are cost-effective, easy to fit and program, can be retrofitted and do not require complex wiring or external power. Programming options include remote code generation, audit trail and code free options, along with a variety of other functions to suit your needs.



### ACCESS CONTROL

Control + Convenience is at the heart of all our products.



### SMART THINKING

We strive to create innovative solutions, not just locks.



### DESIGN + DELIVER

High quality products, designed in-house and delivered globally.



### FIRST CLASS SUPPORT

We provide hands on, expert sales, marketing and technical support.

## Simple access control

Codelocks offer an extensive product range that allows the locks to service a wide variety of applications. From more traditional mechanical locks to cutting-edge electronic and smart products, locks can be newly installed or retrofitted, and many models can be re-programmed on the door, without the need for lock removal. Codelocks is constantly utilising and developing the latest technology to improve the functionality of its locks including remote code generation (NetCode®), which allows codes to be issued remotely, using a web portal or smartphone app. Smart locks enable even more convenient access control.

## Digital lock innovators and experts

With over 30 years of security industry knowledge, Codelocks has the technical expertise to help you find the right access control solution that works for your application. With so much choice available, Codelocks is always on hand to help you select which access control solution works with your current systems, meets your budget and addresses the requirements of your buildings and people. Codelocks develop locks to meet the demands of changing environments, improving customer experience.

## Passionate about quality

Founded in 1991, Codelocks is a global business with its company headquarters in the UK, based in Newbury, Berkshire. It also has offices in Europe, North America and Australia. Codelocks is committed to delivering the highest quality products to both commercial and domestic customers worldwide. The locks are designed in the UK with ease of use in mind, combining functionality with style. The Codelocks factories are accredited with the ISO 9001:2015 quality standard.

## First class support

Codelocks has a dedicated technical team which is on hand to respond to any questions or queries. The team draws on its expert knowledge to offer advice and support both pre- and post-sales, whether that involves specifying the right product for a specific application or providing installation instructions. From one-off orders to large contracts, the high level of customer service remains the same. All prospective and existing customers have access to this source of specialist information and support. Codelocks also offers industry-specific training courses that can be tailored to meet varying customer needs.



L1CB-01

L1CB-02

L1CB-03

L1CB-04

L1CB-05

L1CB-06

L1CB-07

L1CB-08

L1CB-09

L1CB-10

L1CB-11

L1CB-12

L1CB-13

L1CB-14

L1CB-15

L1CB-16

L1CB-17

L1CB-18

L1CB-19

L1CB-20

L1CB-21

L1CB-22

L1CB-23

L1CB-24

L1CB-25

L1CB-26

L1CB-27

L1CB-28

L1CB-29

L1CB-30

L1CB-31

L1CB-32

L1CB-33

L1CB-34

L1CB-35

L1CB-36

L1CB-37

L1CB-38

L1CB-39

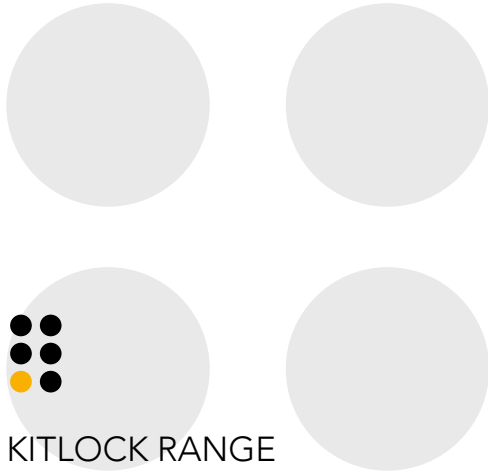

## KITLOCK RANGE

Go Keyless. Go KitLock.

KitLock is a stylish and convenient alternative to traditional locks and keys, using four digit codes and smart cards rather than a key to secure cupboards, drawers, lockers and cabinets in gyms, leisure centres, spas, schools, hospitals, data centres, offices, warehouses - any cabinet and locker application!

- On the door programming
- Quick retrofit to existing cam locks
- Silver grey or black finishes
- NetCode® technology
- User-friendly
- Smart card access options

# SIMPLE MECHANICAL KITLOCK



Introducing the KitLock KL10. Designed with simplicity in mind, the KL10 offers mechanical keyless access suitable for a variety of lockers, cabinets and cupboards.

A durable, compact, easy to use mechanical lock. Designed to be both retrofitted or installed on new cabinets. Changing or resetting the code can be completed easily whilst the lock is still on the door, or if the code has been forgotten it can be retrieved using the master key.



Easy to  
install



Mechanical  
keyless access



One year  
guarantee\*



Private and  
Public Functions

## FEATURES

- Easy to install and retrofit
- Locked and unlocked indicators
- 4 wheel code combination
- Up to 10,000 unique combinations
- Black powder coated finish
- Private and Public Function
- Easy grip outer casing
- Code retrieval function
- Master key available
- Suitable for internal use only

## FUNCTIONS



### Private Function

The KL10 Private Function is ideal for use where the same, personal 4 digit code will be repeatedly used, e.g. an employee with the same locker/drawer in the workplace.



### Public Function

The KL10 Public Function is ideal for short term, multiple occupancy applications. The user enters a personal four digit code, this locks the lock. The same code is entered once only to open the lock, the lock remains open ready for the next user.



### Code Retrieval

This function requires the Master Key (sold separately). Allows a code to be retrieved should it be forgotten or emergency access is required.



## TECHNICAL SPECIFICATIONS

| FEATURE        | DESCRIPTION   |
|----------------|---|
| Functions      | Private or Public Function  |
| Housing        | Zinc Alloy  |
| Code Length    | 4 digit   |
| Code Storage   | Single code   |
| Suitable For   | Internal applications only  |
| Spindle Length | Fixed spindle suitable up to 18mm (11/16") thick  |
| Handing        | Non-handed  |
| Door Prep      | 19mm (3/4") diameter  |
| Indicators     | Locked / unlocked   |
| Fixings        | Nut supplied - additional washer / clip available separately                            |
| Cam            | 44.7mm (1 3/4") straight cam and 50mm (2") crank cam supplied with retail boxed product |

Note: Not suitable for Chlorine environments.

## PRODUCT DIMENSIONS

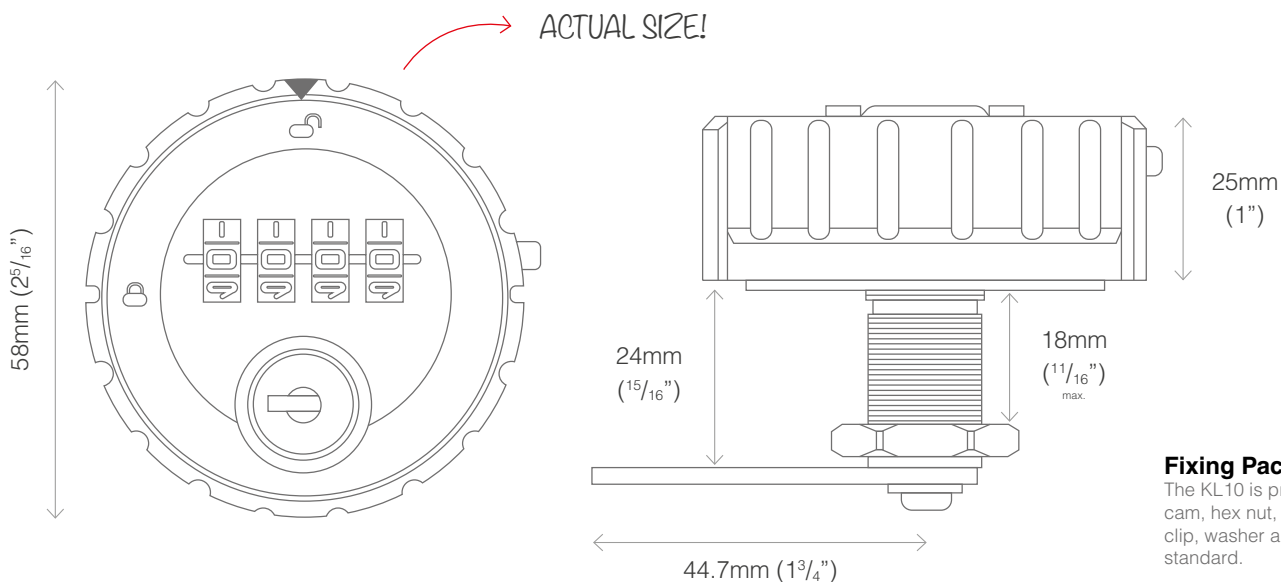

### Fixing Pack

The KL10 is provided with a straight cam, hex nut, cranked cam, metal clip, washer and three screws as standard.



Scan to shop!

[www.kitlock.com](http://www.kitlock.com)





# ANTI-VANDAL MECHANICAL KITLOCK



Simple, tough and good value for money, the KL15 offers mechanical keyless access with Private or Public Function models suitable for a variety of locker and cabinet applications.

The KL15 can be surface mounted with an ergonomically designed surface trim plate that provides additional grip allowing ease of opening. If it's a sleek look that will better suit the application, the KL15 can also be flush fitted.



Easy to install



Mechanical keyless access



One year guarantee\*



Private and Public Functions

## FEATURES

- Code retrieval function
- Flush or surface mounted
- Anti-vandal handle
- Salt spray tested
- High / low temperature tested
- High / low humidity tested
- 4 wheel combination
- Up to 10,000 unique combinations
- Locked / unlocked indicators
- Private and Public Function
- Suitable for internal and external applications

## FUNCTIONS



### Private Function

The KL15 Private Function is ideal for use where the same, personal 4 digit code will be repeatedly used, e.g. an employee with the same locker/drawer in the workplace.



### Public Function

The KL15 Public Function is ideal for short term, multiple occupancy applications. The user enters a personal four digit code, this locks the lock. The same code is entered once only to open the lock, the lock remains open ready for the next user.



### Code Retrieval

Use the Master Key to retrieve the forgotten code by simply turning the dials individually until the correct code 'clicks' into place.



### Installation

The KL15 can be installed to fit either flush or surface mounted applications. All necessary fixings are supplied with the lock.



## TECHNICAL SPECIFICATIONS

| FEATURE       | DESCRIPTION  |
|---------------|--|
| Functions     | Private or Public Function   |
| Code Length   | 4 digit  |
| Code Storage  | Single code  |
| Suitable For  | Internal and external applications   |
| Surface Mount | Fixed spindle suitable for panel thickness 0.8mm - 18mm ( $1/32''$ - $11/16''$ ) |
| Flush Fit     | Suitable for panel thickness 0.8mm - 36mm ( $1/32''$ - $13/8''$ )                |
| Handing       | Vertical, right hand and left hand   |
| Indicators    | Locked (red) / unlocked (green)  |
| Fixings       | All surface mount and flush fit fixings supplied as standard                     |
| Cam           | Flat and cranked cam supplied as standard  |

## PRODUCT DIMENSIONS



Scan to shop!

[www.kitlock.com](http://www.kitlock.com)



# AUTO SCRAMBLE MECHANICAL



Designed with simplicity in mind, the KL20 offers mechanical keyless access suitable for a variety of lockers, cabinets and cupboards.

A simple robust mechanical lock. Tough alloy front and handle. Flush mounted ideal for personal storage in offices, schools and colleges. The user selects their own 4 digit code and this remains unchanged until they wish to alter it. The user can change their code at anytime and the KL20 has the added security and convenience of an auto scrambling function. The dials automatically scramble to 0-0-0-0 when the lock is used, thus hiding the user code from others.



Easy to  
install



Mechanical  
keyless access



One year  
guarantee\*



Private Function  
Only

## FEATURES

- No keys to manage
- Code retrieval function
- Auto code scramble function
- 4 wheel code combination
- Black powder coated finish
- Locked / unlocked indicators
- Available vertical, right hand and left hand
- Private Function only
- Suitable for indoor use only

## FUNCTIONS



AUTO  
SCRAMBLE!



### Private Function

This function is used where the same code will be repeatedly used, e.g. an employee with the same locker/drawer in the workplace.



### Code Retrieval

This function requires the Master Key (sold separately). Allows a code to be retrieved should it be forgotten or emergency access is required.

## TECHNICAL SPECIFICATIONS

| FEATURE        | DESCRIPTION  |
|----------------|--|
| Functions      | Private Function only  |
| Housing        | Zinc Alloy front - plastic rear  |
| Code Length    | 4 digit  |
| Code Storage   | Single code  |
| Suitable For   | Internal applications only   |
| Spindle Length | Fixed spindle suitable for panel thickness 0.8mm - 22mm ( $\frac{1}{32}$ " - $\frac{7}{8}$ " ) |
| Handing        | Vertical, right hand and left hand   |
| Door Prep      | 83mm x 27mm ( $3\frac{1}{4}$ " - $1\frac{1}{16}$ " )   |
| Indicators     | Locked (red) / unlocked (green)  |
| Fixings        | Back plate(s) and cam supplied<br>Additional back plate and cam available                      |
| Cam            | 40mm ( $1\frac{9}{16}$ " ) straight cam supplied   |

Note: Not suitable for Chlorine environments.

## PRODUCT DIMENSIONS

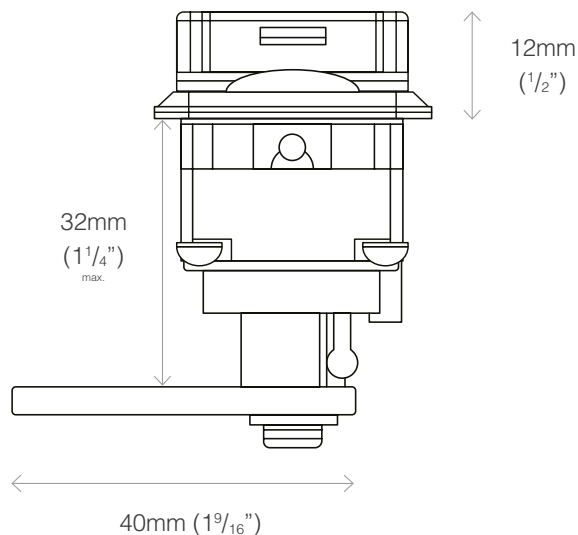
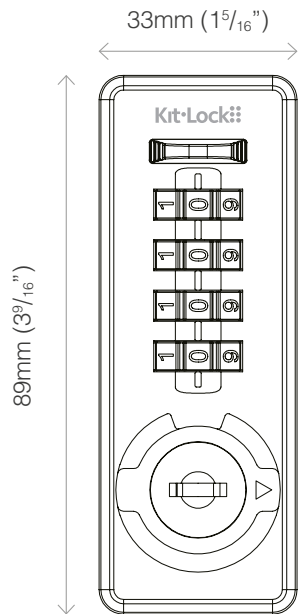

### Fixing Pack

The KL20 is provided with a straight cam, back plate(s) and fixing screws as standard. An additional back plate and cranked cam are available to purchase separately.



Scan to  
shop!

[www.kitlock.com](http://www.kitlock.com)





# SIMPLE KEYLESS ACCESS



The KL1000 Classic is a compact digital lock ideal for replacing keyed cam locks commonly supplied on a wide range of lockers, cabinets and cupboards.

This neat lock is easy to fit, taking just a few minutes to remove the existing cam lock and making an additional top fixing. KL1000 Classic can also be fitted to a locker or cabinet that does not have an existing locking device - just drill another hole. Once in place the lock will perform up to 15,000 openings on just two AAA batteries. Access control without the need for keys.



Easy to install



On the door programming



Two year guarantee\*



Private and Public Functions

## FEATURES

- 11 button keypad
- 8 digit Master and Sub-Master Code
- 4 digit User Code
- 6 digit Technician Code
- Left hand and right hand versions available
- Up to 15,000 operations from 2 x AAA batteries (supplied)
- Battery override
- Slam latch accessory available
- IP55 rated when fitted with gasket
- All parts / fixings / templates included

## FUNCTIONS



### Private Function

This is the default function and is already pre-programmed in new locks. This function is used where the same code will be repeatedly used, e.g. an employee with the same locker/drawer in the workplace.



### Public Function

In this function the KitLock operates with a single User Code. The user enters a personal four digit code, this locks the lock. The same code is entered once only to open the lock before automatically being erased and ready for the next user. This function is used for short term, multiple occupancy applications, e.g. hot desking in an office or a locker in a sports club.

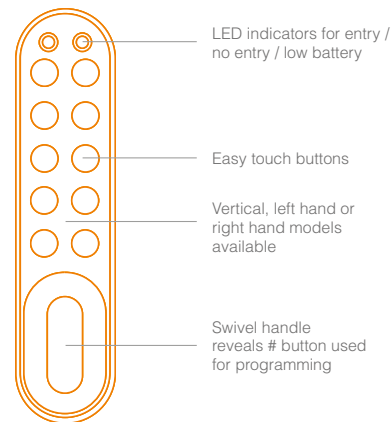

## PRODUCT DIMENSIONS



### Code Management

KL1000 Classic has four code levels available:

- 8 digit Master Code
- 8 digit Sub-Master Code
- 4 digit User Code
- 6 digit Technician Code

The KitLock is supplied with two factory set codes:

- Master Code
- User Code

Before installing, change the Master and User Code by following the Programming and Operating Instructions.

### Easy Installation

Everything you need is included to ensure a quick and easy installation.

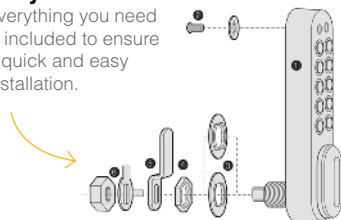

## TECHNICAL SPECIFICATIONS

| FEATURE             | DESCRIPTION   |
|---------------------|---|
| Operations          | Up to 15,000 opening per 2 x 1.5 AAA batteries                                      |
| Battery Override    | A 9 volt PP3 battery can be placed against external contacts                        |
| Low Battery Warning | Red LED will flash on opening to indicate low battery                               |
| Functions           | Private and Public  |
| Buttons             | 11 individual round buttons   |
| Material            | Zinc Alloy  |
| Finish Colour       | Silver grey and black as standard   |
| Door Thickness      | Ready to fit doors up to 25mm (1")  |
| Memory              | Non-volatile memory will be retained  |
| Fitting             | Easy to install and program   |
| Fitting Options     | Vertical, right hand and left hand models   |
| IP55 Rated          | When used with rubber gasket (available separately)                                 |
| Slam Latch          | Retrofit to existing KL1000 Classic locks or purchase for new locks. Easy shutting. |

Note: Not suitable for Chlorine environments.



Scan to shop!

[www.kitlock.com](http://www.kitlock.com)





# SMART CARD ACCESS



The KL1000 RFID is a simple, smart card KitLock providing codeless and keyless access to lockers, cabinets, cupboards and enclosures.

The KL1000 RFID KitLock offers functions for single users (Private Function) and short term use by multiple users (Public Function). The KL1000 RFID can be easily fitted to replace an existing cam lock, or to fit to a new locker or cabinet that does not have an existing locking device. The lock will perform up to 15,000 openings on just two AAA batteries.



Easy to install



Smart card access control



Two year guarantee\*



Private and Public Functions

## FEATURES

- MIFARE® compatible
- Master User Card
- Technician Card
- Public Pairing Feature\*\*
- Any orientation
- Up to 15,000 operations from 2 x AAA batteries (supplied)
- Battery override
- Slam latch accessory available
- IP55 rated when fitted with gasket
- All parts / fixings / templates included

# FUNCTIONS



## Private Function

This is intended for use where there is a single user. Up to 50 individual MIFARE® cards can be registered on the lock and only those registered cards can continue to unlock that lock. The Master Card is used to open a lock, register a new User Card and remove a User Card. The Technician Card is not available in this function. Dedicated and existing MIFARE® cards can be used, no need to purchase new smart cards.



## Public Function

Suitable for short term use by different users. Touch a MIFARE® smart card to lock the lock and then use the same card to unlock the lock, leaving the lock in that unlocked state for any other compatible card to be used. Pre-registration of the card is not required and any new or existing MIFARE® card, fob or wristband can be used. Suitable for use in short-term multi-occupancy applications such as leisure centres, spas and hotels.

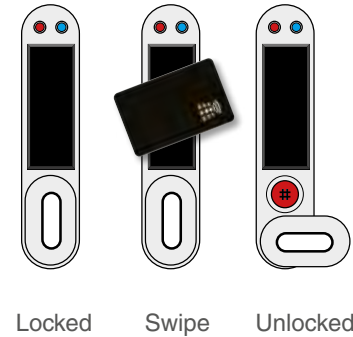

# PRODUCT DIMENSIONS



## Card Management

### Master Card

The Master Card is used to open the lock and delete the currently in-use User Card. The lock will return to an unlocked state.

### Technician Card

The Technician Card is used to open the lock and retain the currently in use User Card. The lock will return to a locked state.

### Public Pairing Feature

The Public Pairing Feature prevents the same card from locking multiple locks that are operating in Public Function.

\*\* Public Pairing Feature is only supported with MIFARE® classic smart cards.

## Easy Installation

Everything you need is included to ensure a quick and easy installation.

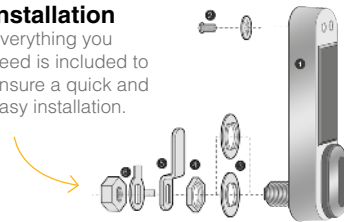

# TECHNICAL SPECIFICATIONS

| FEATURE             | DESCRIPTION  |
|---------------------|--|
| Operations          | Up to 15,000 opening per 2 x 1.5 AAA batteries                                   |
| Battery Override    | A 9 volt PP3 battery can be placed against external contacts                     |
| Low Battery Warning | Red LED will flash on opening to indicate low battery                            |
| Functions           | Private and Public   |
| Material            | Zinc Alloy   |
| Finish Colour       | Silver grey  |
| Door Thickness      | Ready to fit doors up to 25mm (1")   |
| Memory              | Non-volatile memory will be retained   |
| Fitting             | Easy to install and program  |
| Fitting Options     | Any orientation in 45 degree increments  |
| IP55 Rated          | When used with rubber gasket (available separately)                              |
| Slam Latch          | Retrofit to existing KL1000 RFID locks or purchase for new locks. Easy shutting. |

Note: Not suitable for Chlorine environments.



Scan to shop!

[www.kitlock.com](http://www.kitlock.com)





# THIRD GENERATION KL1000



Applying advanced technology to our core products. The KL1000 G3 KitLock offers key override and front battery change capabilities providing ease of use and peace of mind.

The updated chrome effect back panel and handle finishes reflect their surroundings giving the lock a slimmer, more subtle aesthetic. Sharing the same fittings & fixings as the KL1000 Classic, this lock is easily retrofitted, ideal for upgrading existing cabinet and locker installations with increased flexibility and convenience for both guests and staff.



Easy to install  
or retrofit



Key Override  
capability



Front battery  
change



Private and  
Public Functions

## FEATURES

- Keyless entry
- Easy install or retrofit
- Front battery change
- Key Override
- Private and Public Functions
- Up to 20 User Codes
- Auto-unlock after a set time
- Slam latch accessory available
- Black Chrome / Silver Chrome finishes
- Two year guarantee\*

# FEATURES



## Private Function

This function is used where the same code will be repeatedly used, e.g. an employee with the same locker/drawer in the workplace.



## Public Function

This is the default function and is already pre-programmed in new locks. In this function the KitLock operates with a single User Code. The user enters a personal four digit code, this locks the lock. The same code is entered once only to open the lock before automatically being erased and ready for the next user. This function is used for short term, multiple occupancy applications, e.g. hot desking in an office or a locker in a sports club.



## Key Override

Allows key holders to access the locker in the event of a forgotten code or an emergency. Override key available separately.



## Front Battery Change

The KL1000 G3 battery compartment can be accessed via the front of the lock, eliminating the need for battery override. Entering a valid code and turning the handle reveals a security screw which, once removed, allows the cover to slide up and batteries to be replaced.



## 24hr Auto-Unlock Countdown Timer

When operating in Public Function, the KL1000 G3 can be programmed to auto-unlock between 1 and 24 hours after locking\*\*, saving valuable locker management time.



## 20 User Codes

The KL1000 G3 offers up to 20 unique 4 digit User Codes when operating in Private Function, thus allowing a single cabinet to be accessed by multiple users.



## Easy Retrofit

The KL1000 G3 shares the same fittings and fixings as all KL1000 KitLocks, therefore existing installations can be easily upgraded and retrofitted in a matter of minutes.



KL1000  
Third generation.

# TECHNICAL SPECIFICATIONS

| FEATURE             | DESCRIPTION   |
|---------------------|---|
| Code Length         | 8 digit Master and Sub-Master Code, 6 digit Technician Code , 4 digit User Code                         |
| Key Override        | Override key available separately   |
| Operations          | Up to 100,000 operations per 2 x AAA batteries  |
| Low Battery Warning | Red LED will flash on opening to indicate low battery   |
| Fitting Options     | Vertical, right and left hand models  |
| IP54 Rated          | When used with gasket (available separately) IP55 available for special order                           |
| Cam                 | Flat and cranked cam supplied   |
| Door thickness      | Ready to fit doors up to 25mm (1")  |
| Spindle             | Fitted with 24mm (15/16") spindle as standard, optional 10mm (3/8") and 29mm (1 1/8") spindles supplied |
| Slam Latch          | Retrofit to existing KL1000 G3 locks or purchase for new locks (available separately)                   |

Note: Not suitable for poolside lockers.

\*\*Up to 24hrs. Locks can be configured to auto-unlock between 1-24hrs, within +/- 30 minutes of the time period.



Scan to shop!

[www.kitlock.com](http://www.kitlock.com)





# ACTIVATE GENERATE CONTROL



The KL1000 NetCode® provides the smart way to generate time-sensitive codes for a wide range of lockers and cabinets.

Through the online Codelocks Connect Portal or via the Codelocks simple API, you can create codes that have a specified start date, time and duration. Once the duration expires, the codes no longer work. Using time-sensitive codes is a more convenient way to grant access as the code will not work outside a designated timeslot. Issue codes to visiting service engineers, delivery personnel (drop boxes), and medium-term locker rental. Generated codes can be sent by email or SMS.\*\*



Easy to install



On the door programming



Two year guarantee\*



Private and Public Functions

## FEATURES

- Create codes for short, medium and long term
- Web based NetCode® generation
- Send generated codes via email or SMS\*\*
- Three modes of operation
- Four types of NetCode®
- Up to 15,000 operations from 2 x AAA batteries (supplied)
- Battery override
- No WiFi connection required
- 11 button keypad
- Master, Sub-Master, User and Technician Codes
- IP55 rated when fitted with gasket
- All parts / fixings / templates included

# FUNCTIONS



## Three Modes of Operation

The KL1000 NetCode® retains the standard Public and Private Functions.

## NetCode®

This function allows temporary access. Create date and time-sensitive codes via the Codelocks Connect Portal or your own application with our simple API (application programming interface).

## Private Function

This function is used where the same code will be repeatedly used. Choose a single four digit User Code to use multiple times. Ideal for use where the lock is allocated to a single person for a long period of time.

## Public Function

This function is used for short-term, multiple occupancy applications. Enter a four digit User Code to lock the locker, the same code is used to unlock. The lock remains open, ready for a new user and a new code.

# TYPES OF NETCODE®

Four types of NetCode® are available:

- Short term multi-use codes with durations from 1 to 12 hours and 1 to 7 days
- Short term single-use codes with durations from 1 to 12 hours and 1 to 7 days
- Medium term codes with durations from 1 to 21 days
- Long term codes that work for periods of up to 1 year

# ADDITIONAL NETCODE® FEATURES

## Block Previous NetCode®

This feature automatically blocks the last used NetCode® when a new NetCode® is entered.

## Mode Restrictions

Choose which types of NetCode® to support. This is a useful feature if the number of potentially available NetCodes needs to be reduced.

## Block Specific NetCode®

Block a specific NetCode® directly on the lock using either the Master Code or another valid NetCode®.

## Personal User Code

Allow a NetCode® user to create a personal 4 digit number that retains the same validity period as their originally allocated NetCode®.

# CODELOCKS CONNECT PORTAL

All NetCode® locks are registered via the web-based Codelocks Connect Portal. Once registered, NetCodes can be generated and shared via email and SMS text message.\*\* A built-in history provides an audit of all NetCodes created for each lock.

## Additional Portal Features

### Language

Choose from English and German. Language pack available for translation into other languages.

### NetCode® History

View the NetCodes created for every registered lock on the account.

The Codelocks Connect Portal can be customised via CSS and custom logos added. For CSS customise, a hosting charge is applied. Please contact Codelocks to discuss these options.

### Associate Users

Add additional users to your account. These users can generate NetCodes for your locks.

### Profile Management

Customise notifications and settings.

# API

Codelocks provide a simple API (application programming interface) to enable customers to generate NetCodes via their own applications. All standard NetCode® types can be created via the API. Prior to generating a NetCode®, the lock must be registered via the Codelocks Connect Portal. Please contact Codelocks to discuss these options.

# TECHNICAL SPECIFICATIONS

| FEATURE             | DESCRIPTION  |
|---------------------|--|
| Operations          | Up to 15,000 opening per 2 x 1.5 AAA batteries               |
| Battery Override    | A 9 volt PP3 battery can be placed against external contacts |
| Low Battery Warning | Red LED will flash on opening to indicate low battery        |
| Functions           | Private, Public and NetCode®                                 |
| Buttons             | 11 individual round buttons                                  |
| Material            | Zinc Alloy   |
| Finish Colour       | Silver grey as standard                                      |
| Door Thickness      | Ready to fit doors up to 25mm (1")                           |
| Memory              | Non-volatile memory will be retained                         |
| Fitting             | Easy to install and program                                  |
| Fitting Options     | Vertical, right hand and left hand models                    |
| IP55 Rated          | When used with rubber gasket (available separately)          |

Note: Not suitable for Chlorine environments.

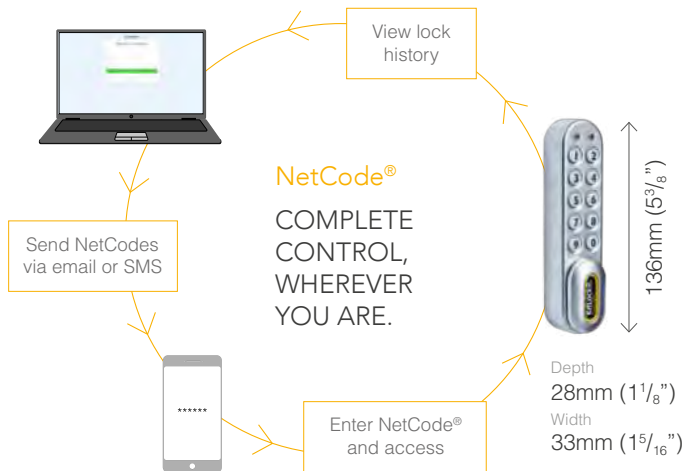

[www.kitlock.com](http://www.kitlock.com)





# THIRD GENERATION NETCODE®



The KL1000 G3 NetCode® utilises technology that allows generation of date and time-sensitive, temporary access codes: NetCodes.

The updated chrome effect back panel and handle finishes reflect their surroundings giving the lock a slimmer, more subtle aesthetic. The KL1000 G3 NetCode® offers key override and front battery change capabilities providing ease of use and peace of mind. Sharing the same fittings & fixings as the KL1000 Classic, this lock is easily retrofitted, ideal for upgrading existing installations with increased flexibility and convenience for both guests and staff.



Easy to install  
or retrofit



Key Override  
capability



Front battery  
change



Private and  
Public Functions

## FEATURES

- Date/time specific code generation
- Send generated codes via email or SMS\*\*
- No WiFi connection required
- Easy install or retrofit
- Silver Chrome finish
- Master, Sub-Master, User and Technician Codes
- Up to 20 User Codes
- IP54 Rated when used with gasket (available separately)
- Two year guarantee\*
- All parts / fixings / templates included

# FUNCTIONS



## Three Modes of Operation

The KL1000 G3 NetCode® retains the standard Public and Private Functions.

## NetCode®

This function allows temporary access. Create date and time-sensitive codes via the Codelocks Connect Portal or your own application with our simple Application Programming Interface (API).

## Private Function

This function is used where the same code will be repeatedly used. Choose a single four digit User Code to use multiple times. Ideal for use where the lock is allocated to a single person for a long period of time.

## Public Function (default)

This function is used for short-term, multiple occupancy applications. Enter a four digit User Code to lock the locker, the same code is used to unlock. The lock remains open, ready for a new user and a new code.

# TYPES OF NETCODE®

Four types of NetCode® are available:

- Short term multi-use codes with durations from 1 to 12 hours and 1 to 7 days
- Short term single-use codes with durations from 1 to 12 hours and 1 to 7 days
- Medium term codes with durations from 1 to 21 days
- Long term codes that work for periods of up to 1 year

# ADDITIONAL NETCODE® FEATURES

## Block Previous NetCode®

This feature automatically blocks the last used NetCode® when a new NetCode® is entered.

## Mode Restrictions

Choose which types of NetCode® to support. This is a useful feature if the number of potentially available NetCodes needs to be reduced.

## Block Specific NetCode®

Block a specific NetCode® directly on the lock using either the Master Code or another valid NetCode®.

## Personal User Code

Allow a NetCode® user to create a personal 4 digit number that retains the same validity period as their originally allocated NetCode®.

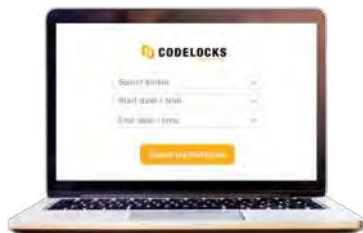

# API

Codelocks provide a simple Application Programming Interface (API) to enable customers to generate NetCodes via their own applications. All standard NetCode® types can be created via the API. Please contact Codelocks to discuss these options.



All NetCode® locks are registered via the online Codelocks Connect Portal. Once registered, NetCodes can be generated and shared via email and SMS\*. A built-in history provides an audit of all NetCodes created for each lock.

## Language

Choose from English and German. Language pack available for translations into other languages.

## Associate Users

Add additional users to your account. These users can generate NetCodes for your locks.

# TECHNICAL SPECIFICATIONS

| FEATURE             | DESCRIPTION  |
|---------------------|--|
| Codes               | Master, Sub-Master, User and Technician Codes  |
| Operations          | Up to 100,000 operations per 2 x AAA batteries   |
| Battery Override    | A 9 volt PP3 battery can be placed against external contacts                                   |
| Low Battery Warning | Red LED will flash on opening to indicate low battery  |
| Functions           | Private, Public and NetCode®   |
| IP54 Rated          | When used with gasket (available separately) IP55 available for special order                  |
| Cam                 | Cranked cam supplied (flat cam available separately)   |
| Door Thickness      | Ready to fit doors up to 19mm (3/4")   |
| Spindle             | Spindles to fit sheet metal doors and door thicknesses up to 25mm (1") available separately    |
| Memory              | Non-volatile memory will be retained   |
| Fitting             | Easy to install and program  |
| Dimensions          | 136mm (5 3/8") H x 28mm (1 1/16") D x 33mm (1 5/16") W   |
| Slam Latch          | Retrofit to existing KL1000 G3 NetCode® locks or purchase for new locks (available separately) |

Note: Not suitable for poolside lockers.



Scan to shop!

[www.kitlock.com](http://www.kitlock.com)



# STYLISH ENHANCED ACCESS

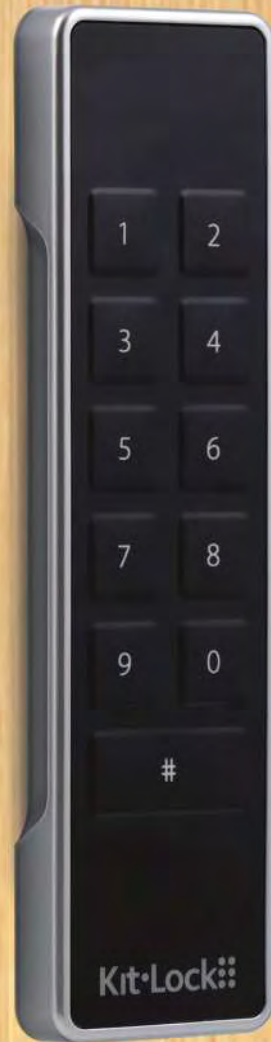

This stylish, standalone lock shares the same slimline design and powered latch as the KL1100 RFID but maintains the traditional code access keypad and features found in classic KitLock products.

The product enhancements make this a front runner for those looking for traditional standalone digital locks with additional User Codes and auto-unlocking capabilities. With up to 100,000 operations, 20 User Codes, Auto-Unlock at a set time or predefined period, this lock is an easy first choice for anybody looking to upgrade their lockers. Available in Metallic Silver or Gloss Black finish, the lock is easy to wipe clean with anti-bacterial wipes and sprays.



Battery  
override



Easy wipe  
clean



Private and  
Public Functions



On the door  
programming

## FEATURES

- 8 digit Master and Sub-Master Code
- 20 User Codes
- 6 digit Technician Code
- Auto-Unlock at a set time
- Maximum locked period
- Battery override
- On the door battery change
- Powered latch
- Supports Private and Public Functions
- IP55 rated when fitted with gasket
- Anti-bacterial wipe clean
- Available in Metallic Silver or Gloss Black

## FUNCTIONS



### Private Function

This is the default function and is already pre-programmed in new locks. This is used where the same code will be repeatedly used, e.g. an employee with a personal locker/drawer.



### Public Function

In this function the KitLock operates with a single User Code. The user enters a personal four digit code, this locks the lock. The same code is entered once only to open the lock and is automatically erased. The lock remains open ready for the next user. This function is used for short term, multiple occupancy applications.

## BENEFITS

### Auto-Unlock at a Set Time (Public)

Configure the lock to automatically unlock at a predefined time.

### Maximum Locked Period (Public)

Configure the lock to automatically unlock after a predefined period.

### Easy Installation

KitLock products are designed for easy install and the KL1100 KeyPad is no different, sharing the same fixing holes as the KitLock KL1000 Classic, retrofit is an option for many applications.

## PRODUCT DIMENSIONS



### Code Management

KL1100 KeyPad has four code levels available:

- 8 digit Master Code
- 8 digit Sub-Master Code
- 4 digit User Code
- 6 digit Technician Code

The KitLock is supplied with two factory set codes:

- Master Code
- User Code

Before installing, change the Master and User Code by following the Programming and Operating Instructions.



129.7mm  
(5 1/8")

68.6mm (2 3/4")

## TECHNICAL SPECIFICATIONS

| FEATURE             | DESCRIPTION  |
|---------------------|--|
| Operations          | Up to 100,000 operations                                 |
| Low Battery Warning | Red LED will flash 3 times before unlocking              |
| Power               | Powered by 4 x 1.5 volt AA batteries (supplied)          |
| Battery Override    | Connect to 5V micro USB power source for temporary power |
| Door Thickness      | Ready to fit doors up to 25mm (1")                       |
| Finish Colour       | Metallic Silver or Gloss Black                           |
| Memory              | Non-volatile memory - programming will be retained       |
| Latch               | Powered latch  |
| Orientations        | Vertical   |
| Material            | Mixed plastic and alloy                                  |
| Functions           | Public and Private                                       |
| IP55 Rated          | When used with gasket supplied                           |

Note: Not suitable for Chlorine environments.



Scan to shop!

[www.kitlock.com](http://www.kitlock.com)







# TAP LOCK GO

The KL1100 RFID lock features a stylish, slimline front plate giving any environment a modern, contemporary feel.

Choose between offline or cloud based software options to configure your locks and cards. The KL1100 is perfect for applications with a large quantity of lockers that would benefit from issuing and managing Card Clients from reception desks, for example, gyms, leisure centres, hospitals, hotels, schools and universities. The KL1100 is easy to install, operate and manage, featuring a powered latch enabling intuitive 'push shut' closing.



Easy to install



Remote Card Authorisation



Two year guarantee\*



Private and Public Functions

## FEATURES

---

- Master Card
- Technician Card
- Standalone Mode
- RCA Mode via offline or cloud based software
- Local management via plug-in programmer
- Date and time based features
- Powered latch
- Battery override
- Override code
- IP55 rated when fitted with gasket supplied
- MIFARE® Classic 1k compatible cards, fobs or wristbands can be used



## STANDALONE MODE

Standalone Mode requires a Keypad Programmer (sold separately) for adding/removing cards and managing functions of the lock.

- Locally manage individual locks
- Supports Private and Public Functions
- Master Card
- Up to 50 User Cards per lock
- Up to 10 Technician Cards per lock

## RCA MODE

Remote Card Authorisation (RCA) Mode offers remote management allowing Card Clients to be authorised via a PC using offline or cloud based software and a USB Card Reader.

- Manage individual or a group of locks
- Supports Private and Public Functions
- Up to 250 locks within a lock group
- Master Card and Technician Cards
- Multiple User Cards per lock

## RCA OVERVIEW

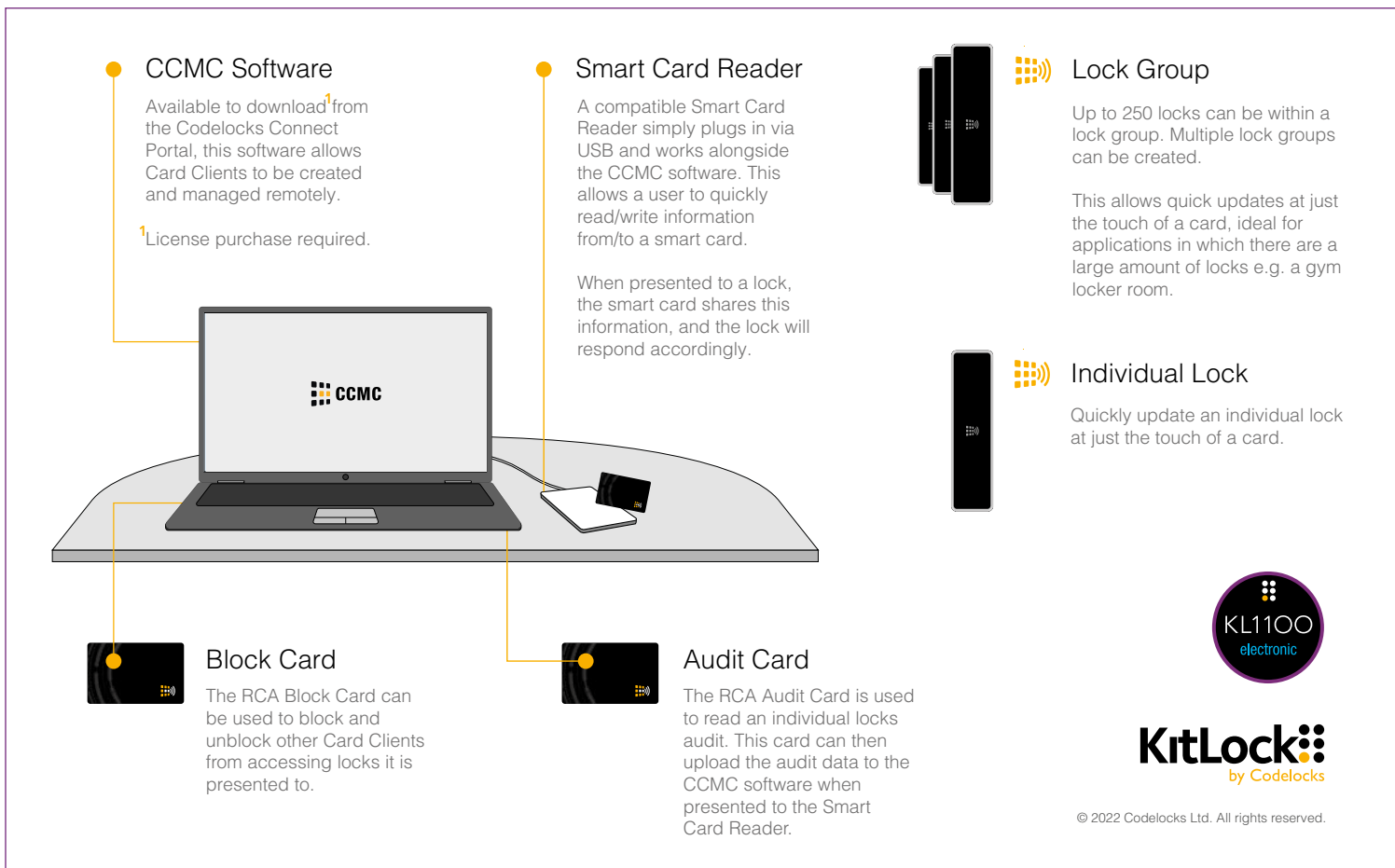

[www.kitlock.com](http://www.kitlock.com)



Remote Card Authorisation



MIFARE® compatible



Stylish slimline profile



Powered latch



## PRIVATE FUNCTION

This function is used where the same pre-registered User Cards are repeatedly used, auto-locking after each opening. Up to 50 individual User Cards, 10 individual Technician Cards and 1 Master Card can be registered per lock.



## PUBLIC FUNCTION

The user presents a compatible card to an available open lock, this locks the lock and only that User Card, or a registered Technician/Master Card can be used to unlock the lock. The lock remains open ready for the next user. This function is used for short-term, multi-occupancy applications.

## DIMENSIONS

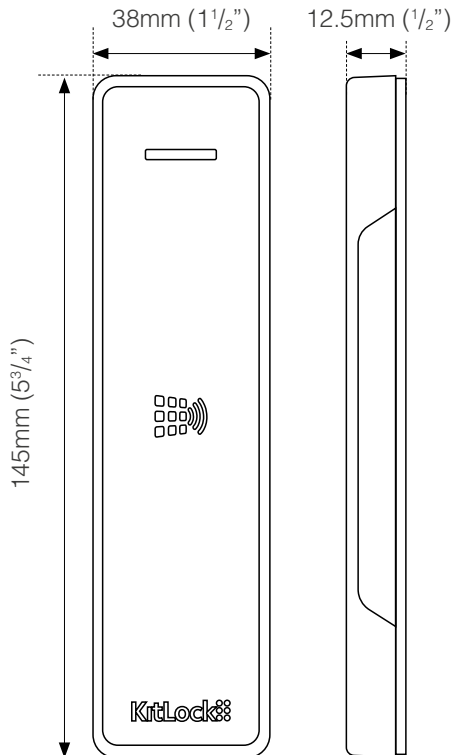

## BENEFITS

### Auto-Unlock at a Set Time (Public)

Configure the lock to automatically unlock at a predefined time.

### Maximum Locked Period (Public)

Configure the lock to automatically unlock after a predefined period.

### Dual Authorisation (Private)

This feature requires any 2 authorised Card Clients (either User or Technician) to be presented within 5 seconds of each other for the lock to unlock.

### Override Code

A 4 digit code that allows emergency access in the event of the Master Card being unavailable. It is recommended an Override Code is created during set up. Programmer required.

## TECHNICAL SPECIFICATION

| FEATURE             | DESCRIPTION   |
|---------------------|---|
| Operations          | Up to 100,000 operations  |
| Low Battery Warning | Red LED will flash 3 times before unlocking   |
| Power               | Powered by 4 x 1.5 volt AA batteries (supplied)   |
| Battery Override    | Connect to 5V micro USB power source for temporary power                                |
| Door Thickness      | Ready to fit doors up to 25mm (1")  |
| Finish Colour       | Metallic Silver or Gloss Black  |
| Memory              | Non-volatile memory - programming will be retained                                      |
| Latch               | Powered latch   |
| IP55 Rated          | When used with gasket supplied  |
| Card Client Types   | Master, Technician, User, Initialisation, Block and Audit - Supports MIFARE® Classic 1k |
| Orientations        | Vertical - Left Hand or Right Hand  |
| Material            | Mixed plastic and alloy   |
| Functions           | Public and Private  |



# ROBUST KEYLESS ACCESS



For more challenging environments, the KL1200 includes all the benefits of the KL1000 but is tougher and more robust.

With additional programming features, stainless steel buttons, dual fixing points and increased battery life, the KL1200 provides enhanced benefits to facilities managers looking to simplify access control without the need for keys. Quick, tough and cost effective.



Easy to install



On the door programming



Two year guarantee\*



Private and Public Functions

## FEATURES

- 11 button keypad
- 8 digit Master and Sub-Master Code
- 4 digit User Code
- 6 digit Technician Code
- Right hand version available
- Up to 50,000 operations from 2 x AAA batteries (supplied)
- Battery override
- Auto unlock feature
- Audible keypad
- Slam latch accessory available
- IP54 rated when fitted with gasket
- All parts / fixings / templates included

# FUNCTIONS



## Private Function

This is the default function and is already pre-programmed in new locks. This function is used where the same code will be repeatedly used, e.g. an employee with the same locker/drawer in the workplace.



## Public Function

In this function the KitLock operates with a single User Code. The user enters a personal four digit code, this locks the lock. The same code is entered once only to open the lock before automatically being erased and ready for the next user. This function is used for short term, multiple occupancy applications, e.g. hot desking in an office or a locker in a sports club.

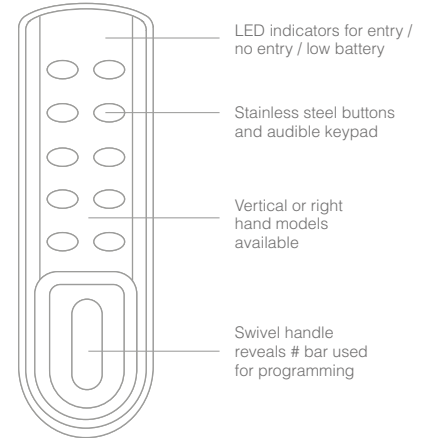

# PRODUCT DIMENSIONS



## Code Management

KL1200 has four code levels available:

- 8 digit Master Code
- 8 digit Sub-Master Code
- 4 digit User Code
- 6 digit Technician Code

The KitLock is supplied with two factory set codes:

- Master Code
- User Code

Before installing change the Master and User Code by following the Programming and Operating Instructions.

## Easy Installation

Everything you need is included to ensure a quick and easy installation.

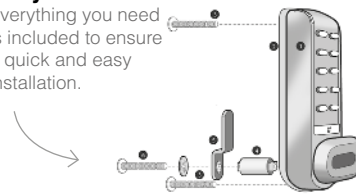

# TECHNICAL SPECIFICATIONS

| FEATURE             | DESCRIPTION  |
|---------------------|--|
| Operations          | Up to 50,000 opening per 2 x 1.5 AAA batteries               |
| Battery Override    | A 9 volt PP3 battery can be placed against external contacts |
| Low Battery Warning | Red LED will flash on opening to indicate low battery        |
| Functions           | Private and Public   |
| Buttons             | 11 individual round buttons                                  |
| Material            | Zinc Alloy   |
| Finish Colour       | Silver grey as standard                                      |
| Door Thickness      | Ready to fit doors up to 25mm (1")                           |
| Memory              | Non-volatile memory will be retained                         |
| Fitting             | Easy to install and program                                  |
| Fitting Options     | Vertical and right hand models                               |
| IP54 Rated          | When used with rubber gasket (available separately)          |
| Slam Latch          | Separate accessory - allows 'push shut' locking of the door  |

Note: Not suitable for Chlorine environments.



Scan to shop!

[www.kitlock.com](http://www.kitlock.com)





## Go Keyless. Go KitLock.

“The KitLock solution is more professional and, from a guest perspective, the lockers are now far more secure as keys are not left lying around in robe pockets. It’s a smarter way to control the lockers as the guests are responsible for using the lockers and selecting their own codes.”

- Champneys Health Spa Resort





**K3 Connect: Setting Up**

1. Install the K3 Connect App on your device
2. Once installed, open K3 Connect and log in
3. The account creation process includes:
  - Create a new account
  - Once the account has been created, click on the 'Add Lock' button
4. To add a new lock, touch the '+' icon on the screen
5. Enter the lock IDN and choose a lock IDN
  - Note: The lock IDN is case sensitive (123456789)
6. In the App, touch 'OK' and then enter:
  - Master Code: (00-1)
  - Default: #12345678-00
7. The lock will now pair with you

**training + support**

Codelocks fully dedicated website offers technical information and support including programming and installation. Watch handy videos on how to fit and perform code changes, read our latest case studies, find out what events we will be attending worldwide, sign up to our newsletter and read our helpful blog. Spare parts and accessories for locks are also available to purchase online.

Simply visit [www.codelocks.com](http://www.codelocks.com)

### Aftercare

No maintenance of the working parts is necessary. Do not oil. To maintain the finish the lock should be cleaned regularly with a soft cloth. A silicon spray or similar should be used to provide a protective film against grit and grime. It is strongly recommended to undertake a regular maintenance schedule and wipe the outer surface of all Codelocks products clean and encourage the displacement of water. Do not use oil-based lubricants as these will attract dirt.

### Training

Codelocks introduced locksmith training courses in 2012. We wanted to work with the people installing and servicing our coded locks on a daily basis. The locksmiths that attend our courses provide us with valuable feedback, allowing us to make further improvements to our product line. In return, we offer the opportunity to refresh their technical knowledge and gain free access to expert tuition. Whether you are a locksmith new to the trade, or part of a well-established Estate & Facilities Management team we can provide a personalised training programme to suit your needs. Please contact Codelocks or visit the website to learn more about this service.

### Service

Most issues relating to Codelocks products can be resolved quickly with our Customer Services team. We offer a full repairs service for all our products. Products still in warranty will be repaired free of charge\*. For products out of warranty or where repair is required due to misuse, abuse or poor fitting, there is a small charge plus costs for any parts required. Either call or email us and we can help you get your lock back up and running.

### Guarantee

Codelocks mechanical locks offer a limited lifetime guarantee; any of our mechanical locks will be repaired, serviced or replaced free of charge if they develop a manufacturing fault. Codelocks electronic locks offer a two year guarantee<sup>1</sup>.

<sup>1</sup>Reparatur, Wartung oder Ersatz liegen im alleinigen Ermessen von Codelocks. Falls ein Produkt nicht mehr hergestellt wird, kann ein alternatives Produkt angeboten werden.

**Disclaimer** for using Codelocks mechanical or electronic digital locks with existing lock cases. When using Codelocks front and back plates only, please test with your lock case to ensure that the latch retracts fully from the code side without too much resistance. Some lock cases have a heavily sprung latch follower for use with unsprung lever furniture. This heavy springing may damage the clutch on our locks. If in doubt do not specify one of our locks with a lock case that is designed for use with unsprung levers. Also ensure that the code on the mechanical locks re-sets or clears. The code chamber requires that the lever is rotates 45 degrees to reset the lock for the next code user. Please contact Codelocks technical support team for further advice. Codelocks does not accept responsibility for products incorrectly specified. Please note that all the product dimensions in this brochure are nominal and subject to tolerances. Whilst every effort has been made to ensure the contents of this publication are accurate, no liability will be accepted by Codelocks (LTD, INC, PTY) for any errors or omissions.



Get in  
Touch!

[www.codelocks.com](http://www.codelocks.com)

© 2023 Codelocks Ltd. All rights reserved.





If you would like to know more about Codelocks and how you can benefit from the control and convenience the locks provide, contact one of our international offices.

**CODELOCKS UK  
HEADQUARTERS**

Tel: +44 (0) 1635 239645  
Fax: +44 (0) 1635 239644  
sales@codelocks.com  
www.codelocks.com

Helpline, service & spares  
Freephone: 0800 393 405

**CODELOCKS INC  
(UNITED STATES)**

Tel: +1 714 979 2900  
Fax: +1 714 979 2902  
sales@codelocks.us  
www.codelocks.us

Helpline, service & spares  
Toll free: 1.877.codelock

**CODELOCKS PTY LTD  
(AUSTRALIA)**

Tel: +61 2 9882 1009  
Fax: +61 2 9882 6030  
sales@codelocks.com.au  
www.codelocks.com.au

Helpline, service & spares  
Toll free: 1800 052 131

**CODELOCKS EU B.V.  
EUROPE**

Tel: +31 53 80 80 118  
sales@codelocks.eu  
www.codelocks.eu



**CODELOCKS**

control + convenience

[www.codelocks.com](http://www.codelocks.com)